



719-694-2112

The Knolls at Sweetgrass

1510 Gatehouse Circle, Colorado Springs, CO 80904

www.aptsct.com/knollsatsweetgrass



OFFICE HOURS

M-F 9-6 SAT-10-5 SUN-11-5

PRICING INFORMATION

SIZE	PRICE	DEPOS	SQ.FT.
1 BD/1 BA	659	200	717
1 BD/1 BA	699	200	787
2 BD/1 BA	749	200	950
2 BD/1.75 BA	859	200	1085
2 BD/2 BA	889	200	1012

Prices Subject To Change Daily.

UTILITIES

Resident pays all

PARKING INFORMATION

Off-street parking. Carport parking.

UNIT AMENITIES

- Refrigerator
- Electric Range
- Dishwasher
- Disposal
- Breakfast Bar
- Walk-in Shower
- Wood Fireplace
- Vaulted Ceiling
- Ceiling Fans
- Wood Floors

COMMUNITY AMENITIES

- Outdoor Pool
- Jacuzzi Spa
- Fitness Center
- Dog Park
- Picnic Area
- BBQ Area
- Business Center
- Coffee Bar
- Internet Café
- Tanning Deck

SCHOOLS

School District: 11
 Elementary: Bristol
 Middle: West
 High: Coronado / Palmer

Washer/Dryer
 Included
 AC

Gazebo
 Pond
 Gated Community

PET INFORMATION

Call for breed restrictions
 Dogs: 2 Cats: 2
 Maximum Pets Allowed: 2
 NR Pet Fee: Cats - \$150. Dogs - \$200-300
 Pet Rent: \$25 mo/per pet
 Weight Limit: 100 lbs for 1st floor, 50 lbs for 2nd floor

F.Y.I.

Application Fee: \$50
 Administration Fee: \$125
 Leases: 3ML, 6ML, 9ML, 12ML,
 Units: 262
 Management: AMC

DIRECTIONS

Traveling north or south on I-25, take Uintah exit and turn west. Follow Uintah over the hill. Turn right just before you get to the shopping center, the Knolls is on the hill.

all info subject to change

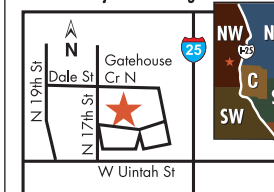

Floor Plans



1 bed/1 bath

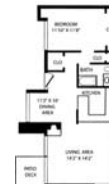

1 bed/1 bath



2 bed/2 bath



2 bed/2 bath



2 bed/1.5 bath